

1. Mechanical Dimensions:

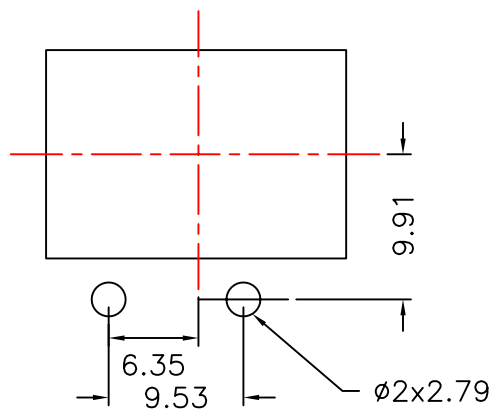

Suggested Pad Layout

2. Schematic:

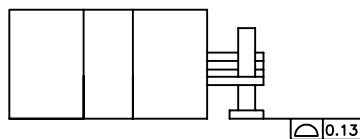
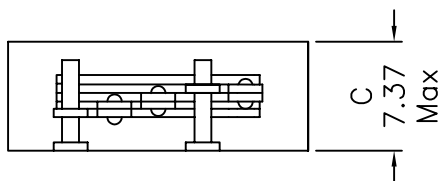
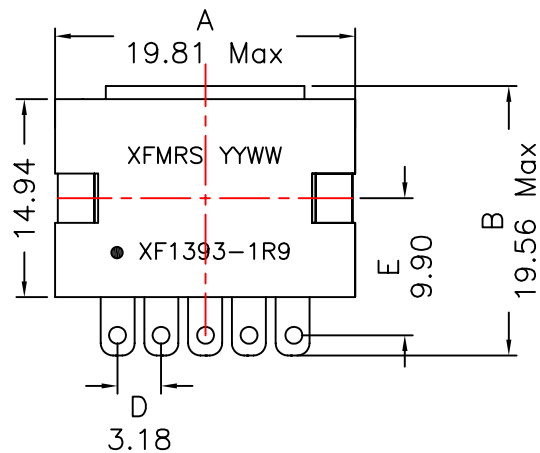
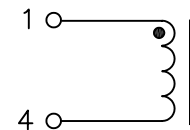

3. Electrical Specifications: (25°C)

OCL: 2.0uH±15% @10KHz 0.1V 0Adc
 1.90uH±15% @10KHz 0.1V 25Adc

DCR: 1.43mOhms Max

Rated: 25Adc

Heating Current: 42.0A (Based on 45°C Temp Rise)

Saturation Current Isat: 29A @25°C (Based on 15% drop in OCL)
 25A @100°C (Based on 15% drop in OCL)

Notes:

1. Solderability: Terminals shall meet, IPC/EIA/JEDEC J-STD-002B
2. Flammability: UL94V-0
3. Operating Temperature Range: -40 to 125°C
4. Storage Temperature Range: -55°C to +125°C
5. Electrical and mechanical specifications 100% tested
6. RoHS Compliant Component

XFMR5 Inc www.XFMR5.com	Title: SMT Power Inductors		
	UNLESS OTHERWISE SPECIFIED	P/N: XF1393-1R9	REV. A
TOLERANCES: .xx ±0.25	DWN.	Xiany	Aug-05-09
Dimensions in MM	CHK.	YK Liao	Aug-05-09
Scale None SHT 1 OF 1	APP.	BW	Aug-05-09

DOC REV: A/1

PROPRIETARY

Document is the property of XFMR5 Group & is not allowed to be duplicated without authorization.